

2021 CLASS A GAS | FORTIS

FleetwoodRV



FORTIS

2021 CLASS A GAS



For our gas chassis, we take the Ford® drivetrain and create a solid platform to build on. The result is enhanced balance and control, as well as the strength to carry more weight. The design also allows for larger pass-through storage.



### Truss Style Platform Chassis

The Truss Style Platform puts strength, stability, and reliability front and center. Perfect for trips requiring large carrying capacities, and built to store everything you need with spacious pass-through storage, the Truss Style Platform is the ideal chassis for optimum balance and control — Found on Fleetwood Fortis gas motorhomes.

Every new adventure requires a solid foundation. The Truss Style Platform is designed with balance, control, a smooth ride, and ample space in mind, all working together to give you a ride like no other RV can provide.



Limited one-year/15,000-mile coach warranty and three-year/45,000-mile structural warranty, whichever occurs first, and it is fully transferable for the first 12 months. RV OWNERCARE is one of the RV industry's most comprehensive programs and includes systems, appliances, components and construction, with no deductible and no service charge.

Chassis Warranty provided by Ford®



## We build strength and quality from the inside out.

Fleetwood's exclusive Powerlock™ system is integrated into all Fleetwood RV Class A Gas models.\*

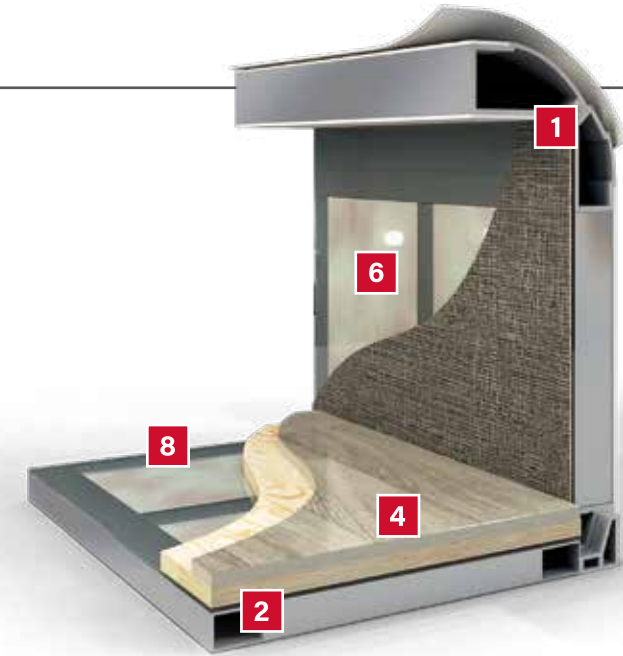

At Fleetwood, we don't settle for anything less than the best and neither should you. That is why every Fleetwood features industry-leading materials and construction standards.

- 1 PowerLock System™ Interlocking Walls & Ceiling**  
Fleetwood's interlocking aluminum extrusion wall-joint system integrates sidewall and roof assembly into one locked-together overall structure for long-term performance and durability.\*
- 2 Precision Welded Joints**  
The all aluminum hull structure is engineered and built to precise tolerances and then precision welded to ensure strength and durability on even the roughest road trip.

\*Powerlock™ is integrated into all Fleetwood Class A Gas models, with some exceptions to Fortis. See dealer for details.

## At Fleetwood RV, it's not just what you see that matters. It's what you don't.

- 3 Tuff-Coat Fiberglass Walls**  
Thicker than other manufacturers, our Tuff-Coat fiberglass walls provide a durable skin and is the perfect surface for an automotive style finish.
- 4 Thick Robust Floor**  
Thicker than the industry standard, Fleetwood engineered the floor for more sound deadening and more insulation which results in a quieter, more comfortable ride no matter the weather or terrain outside.
- 5 Solid Bead-Foam Insulation™**  
Fleetwood's above-standard insulation material and process doesn't allow settling or air gaps to form. There is no forcing the precision cut insulation into position like the roll-type pink fiberglass insulation used by other manufacturers.
- 6 Loctite® Industrial Adhesive**  
Engineered to meet bonding, sealing and assembly requirements for a durable structure with no de-lamination.
- 7 No Wood Substrate**  
Unlike most Class A motorhome manufacturers, you won't find any wood substrate on the exterior walls.
- 8 1/2" Plywood Subfloor**  
Thicker than most competitors who use OSB or chip board, the integrated 1/2" subfloor provides a solid surface for flooring and eliminates movement and flexing while traveling.

- 9 Vacu-Bond™ Construction**  
Fully sealed and weather-resistant, the vacuum-bonded assemblies combine materials and construction for a straight, solid integrated wall that is better suited to withstand the rigors of the road. An adhesive bonding process applies up to 415,000 pounds of vacuum pressure to the welded-aluminum sidewall frame, bead-foam insulation, thick Tuff-Coat fiberglass skin and inner wall materials, far exceeding industry standards.
- 10 CNC Precision Routed Walls and Floors**  
Computer driven routers precisely route walls and floors to fit exact specifications to eliminate gaps, misalignments and provide for a more solid integrated overall structure.



Each of these advantages have been engineered to deliver superior reliability, durability and most of all, customer satisfaction.

**FORTIS 32RW**

Shown in New for Model Year 2021  
Battle Axe Graphics Full Body Paint

**THE NEWCOMER THAT'S TURNING HEADS.**

Fleetwood's newest model has made quite a splash in the industry. Awarded "Top RV Debut" (RV Business) and "Best of Show-New Unit" (RV News), Fortis is demonstrating its strength in the market. But now we've made it even better, with a brand new chassis that can handle up to 26,000 pounds, we've also included an 8,000-pound hitch. Those weight limits allow you to fill up your pass-through storage to your heart's content.

Heated mirrors with turn indicators and side cameras keep you safe while the standard 5.5kW generator, 100w solar panel and 2000w inverter make sure you always have power. Stay on trend with the latest style options, including white painted cabinetry, modern upholstery styles, a stainless steel farmhouse sink and countertop edge design.

Get inside Fortis and find out why this model is creating such a buzz. Floorplans available 32RW, 33HB, 34MB, 36DB.



**FORTIS 32RW**  
Shown in Midtown Decor  
with Heritage Cabinetry



1



2



3



4



5



6

1 Facing booth dinette with Dreameasy® dinette table that converts to additional sleeping space

2 Stainless steel farmhouse sink

3 Frosted inserts in the hand-crafted hardwood cabinetry adds to the attention to detail

4 Booth dinette has additional storage under the bench

5 Standard 68" Sofa Sleeper on the Fortis 33HB adds space for guests

6 Just like-home kitchen with residential refrigerator, 3-burner range with cover and stainless steel over the range microwave, sink covers to gives endless prep workspace when making dinner for the crew

**FORTIS 32RW**

Shown in Midtown Decor with Heritage Cabinetry



Hide-A-Loft™ Standard on all Floorplans





**FORTIS 32RW**

Shown in Manhattan Decor with Greystone Cabinetry





**1** Facing booth dinette with Dreameasy® dinette table converted to additional sleeping space

**2** Stainless steel farmhouse sink comes with solid countertop inserts to have endless prep space

**3** New Heritage painted wood hardwood cabinetry option adds a classic look to any decor

**4** New for 2021 Driver/Passenger caddy area with three cupholders, USBs and various storage compartments

**5** King size bed is standard with designer bedspread, headboard, pillow shams, and pillows

**6** Meal prep with ease on the solid surface countertops plus the glass range cover provides additional countertop space





1



2



3



4



3 From behind the wheel you will feel the power and feel in total control with digital information gauges, cruise control, 6" color monitor for side and rear cameras. Sony® 9" stereo system with Bluetooth® connectivity, CarPlay®, navigation and SiriusXM® ready along with a backup camera.



5

4 Fortis 32RW has a spacious wardrobe and storage in the master bedroom area and you may add the optional washer and dryer stackable units for comfort and convenience



6

5 Fortis 33HB large linen closet  
6 Shower with skylight for the extra headroom  
7 Solid surface sink covers and a glass range cover extend the prep space



7

**FORTIS 33HB**

Shown in Santorini Decor with Cappuccino Cabinetry

**FORTIS**  
**INTERIOR DESIGNER RECOMMENDS:**

Manhattan Decor with Heritage or Greystone Cabinetry

Midtown Decor with Heritage or Greystone Cabinetry

Santorini Decor with Cappuccino or Oxford Cabinetry

*Create a customized look that reflects your personal style.*

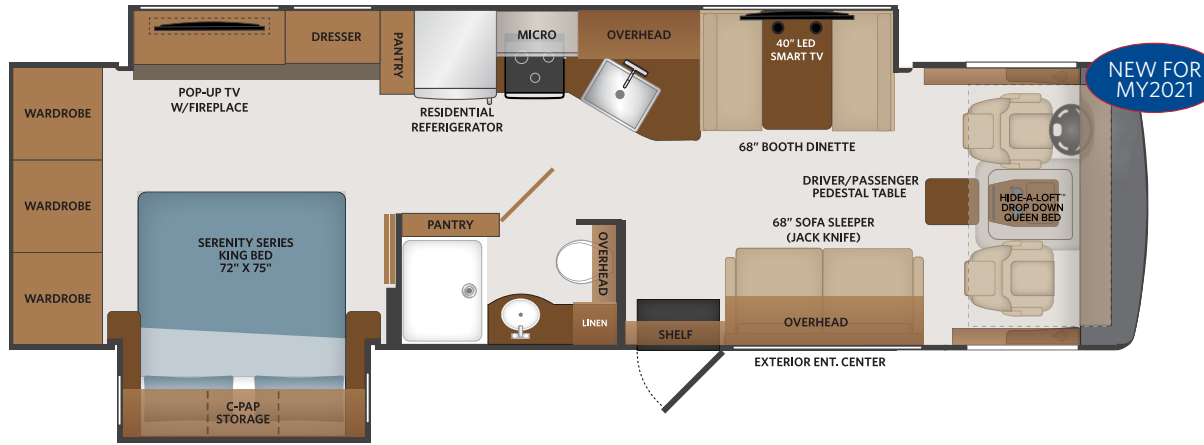

NEW FOR MY2021

### 32RW

Options: 096, 105, 126, 131, 194, 230, 471, 580, 605, 953

#### TOP FLOORPLAN FEATURES

- Sleeps up to 6
- Large Master Bedroom and Wardrobe
- Ducted A/C System
- Stainless Steel Farmhouse Galley Sink
- 3-Burner Gas Range w/Glass Covers
- Sony® Dash Stereo w/CarPlay
- Added Exterior Storage Above the Belt Line

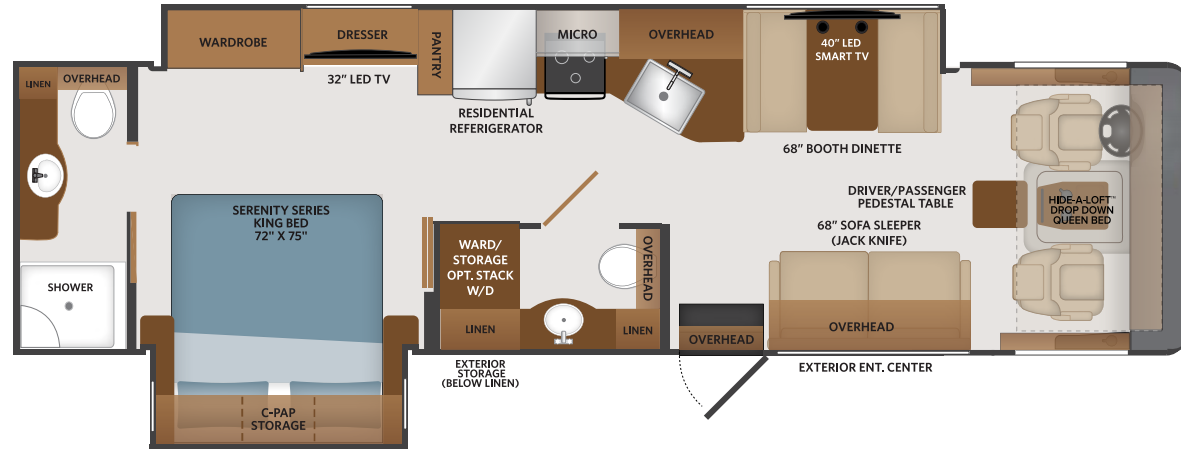

### 33HB

Options: 096, 105, 126, 131, 194, 230, 471, 580, 605, 953

#### TOP FLOORPLAN FEATURES

- Sleeps up to 6
- Bath-and-a-Half
- C-PAP Storage in Bedroom Overhead Cabinetry
- 40\"/>

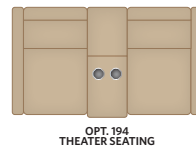

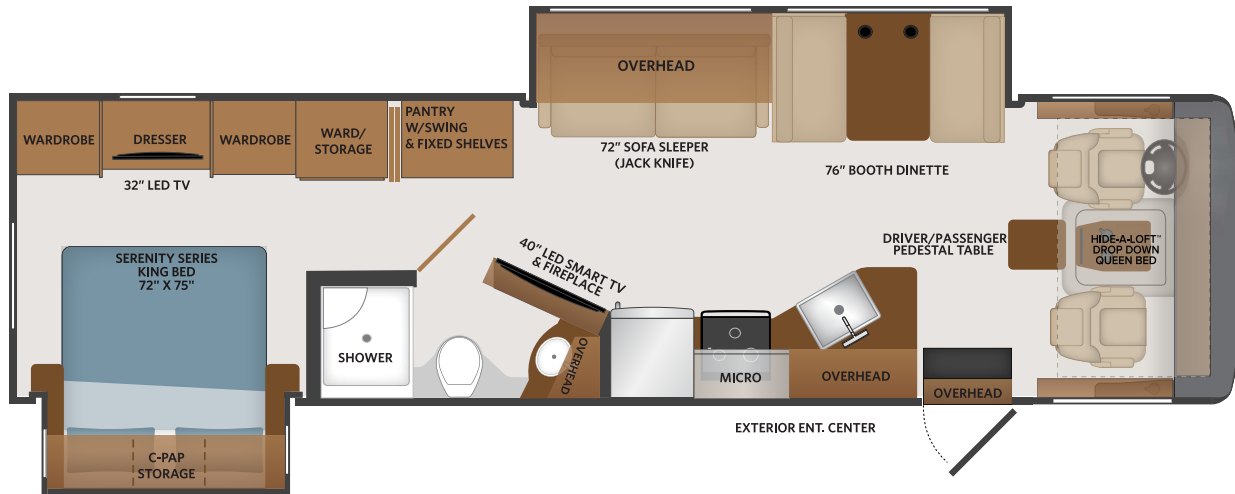

### 34MB

Options: 096, 105, 126, 131, 194, 230, 471, 580, 605, 953

#### TOP FLOORPLAN FEATURES

- Sleeps up to 6
- Sofa Sleeper
- Deep Pantry Storage Functions as a Lazy Susan with Additional Storage Shelves
- IllumaPlex Control System w/App.
- Power Ceiling Vents
- Generous Wardrobe and Dresser Bedroom Storage

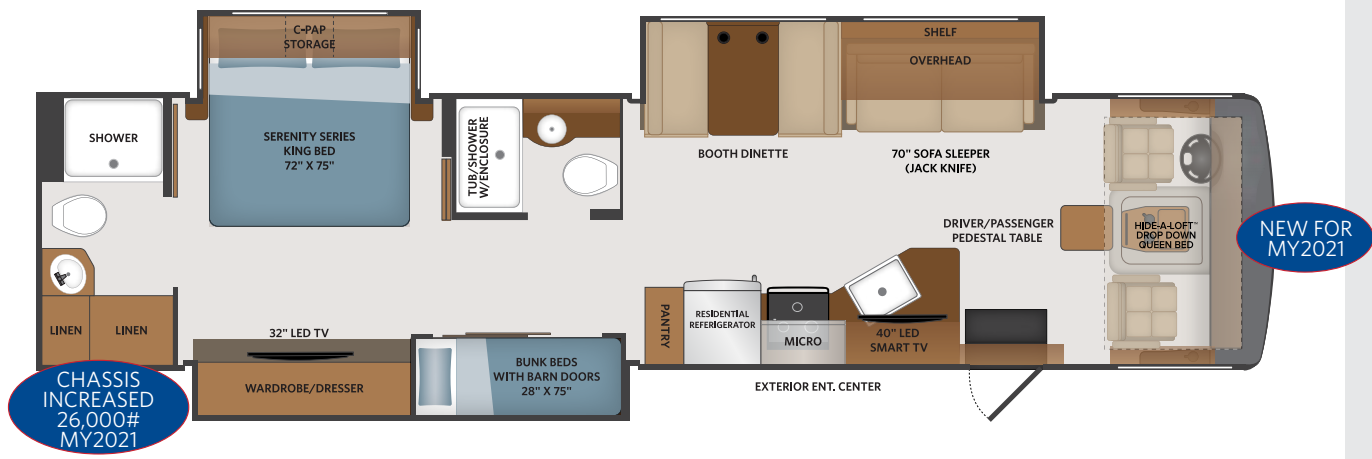

### 36DB

Options: 096, 105, 126, 131, 194, 230, 471, 580, 605, 953

#### TOP FLOORPLAN FEATURES

- Sleeps up to 8
- Bunk Beds 28"x75" with Sliding Barn Doors
- C-PAP Storage in Bedroom Overhead Cabinetry
- IllumaPlex Control System w/App.
- Power Ceiling Vents
- Generous Wardrobe and Dresser Bedroom Storage
- Mid Lavy includes Tub/Shower with Enclosure
- Two Full Lavys
- 26,000# Chassis

CHASSIS INCREASED 26,000# MY2021

NEW FOR MY2021

**FORTIS OPTIONS**

|     |  |     |                            |
|-----|--|-----|----------------------------|
| 096 | KING® Universal Satellite System         | 230 | Roof Vent Rain Covers      |
| 105 | Dometic 8CF Double Door Refrierator - LP | 471 | Steering Stabilizer System |
| 126 | Washer/Dryer — All in one combo          | 580 | Collision Mitigation       |
| 131 | Washer/Dryer — Stackable                 | 605 | Dual Glazed Windows        |
| 194 | Theater Seating                          | 953 | Power Driver Seat          |



## EXTERIOR GRAPHICS



**KHAKI**  
PARTIAL PAINT

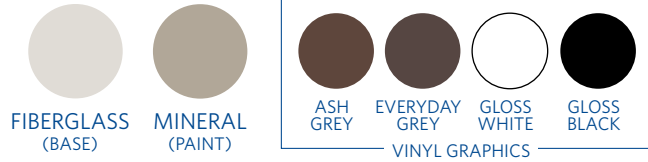

**STARLIGHT**  
PARTIAL PAINT

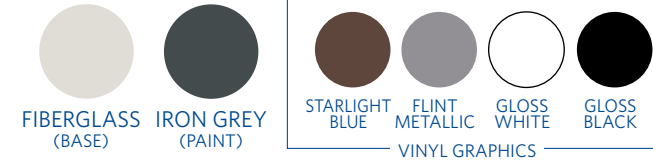

## Premium Four Color, Full Body Paint

NEW FOR  
MY2021



**BATTLE AXE**  
FULL BODY PAINT



**CASTLE ROCK**  
FULL BODY PAINT



INTERIOR DECOR

MANHATTAN

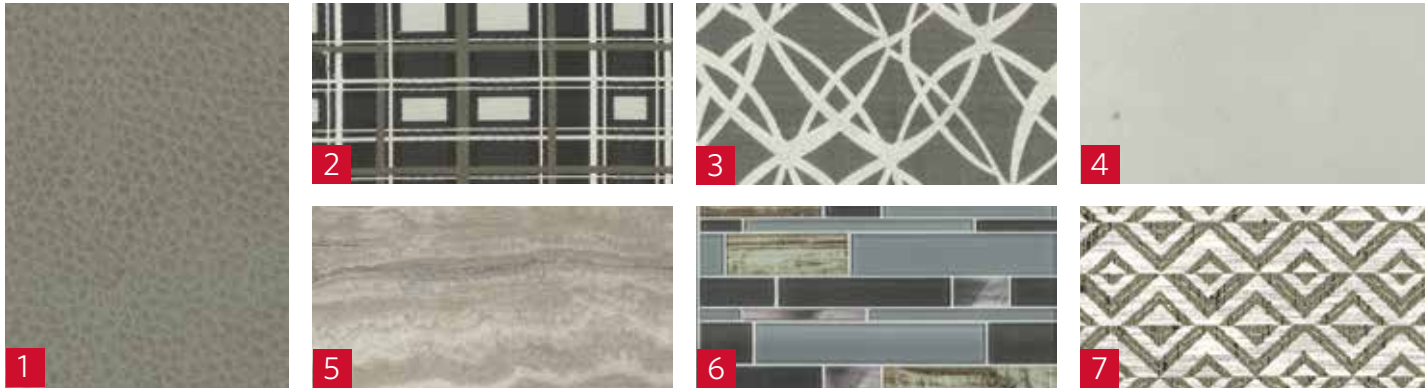

CAPPUCCINO

MIDTOWN

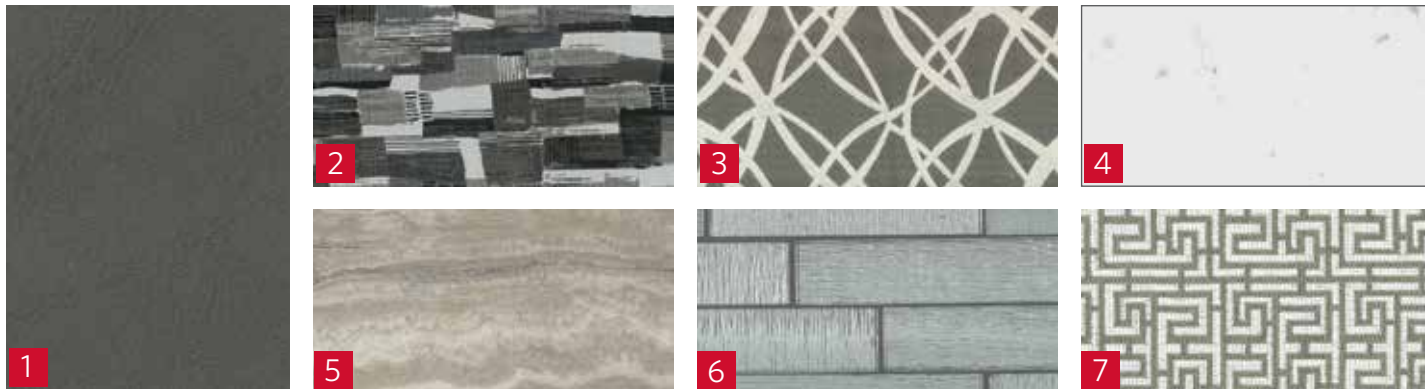

GREYSTONE

SANTORINI

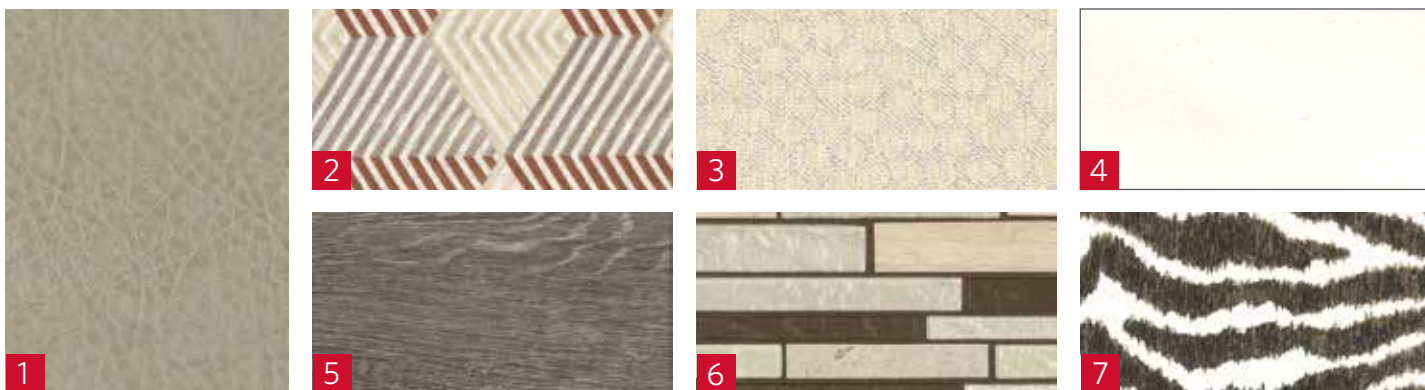

HERITAGE



OXFORD

- 1 SOFA
- 2 LIVING ACCENT
- 3 BEDSPREAD
- 4 COUNTERTOP
- 5 FLOORING
- 6 BACKPLASH
- 7 VALANCE

# FORTIS

| EXTERIOR   | 32RW | 33HB | 34MB | 36DB |
|--|------|------|------|------|
| Aerodynamic Fiberglass Cap w/Hood and Automotive-Style Head-lighting   | S    | S    | S    | S    |
| Rear Fiberglass Cap w/Automotive-Style Lighting                        | S    | S    | S    | S    |
| ABS Wheel Well Trims   | S    | S    | S    | S    |
| Steering Damper  | O    | O    | O    | O    |
| TPO Roof: Thermoplastic Polyolefin                                     | S    | S    | S    | S    |
| Legged Electric Patio Awning w/LED Lighting                            | S    | S    | S    | S    |
| Radiused Entry Door w/Screendoor, Latch, and Deadbolt Lock             | S    | S    | S    | S    |
| Slideout Awning Toppers Above All Slideouts                            | S    | S    | S    | S    |
| Slam Latch Luggage Door Handles, Black                                 | S    | S    | S    | S    |
| Entry Grab Handle  | S    | S    | S    | S    |
| Power Entry Step w/Light   | S    | S    | S    | S    |
| Bottom and Side-Swing Radiused, Color-Matched Fiberglass Baggage Doors | S    | S    | S    | S    |
| Single-Pane Frameless Windows  | S    | S    | S    | S    |
| Dual-Pane Frameless Windows  | O    | O    | O    | O    |
| Patio LED Light  | S    | S    | S    | S    |
| Clearance and Marker Lighting at Front, Side, and Rear                 | S    | S    | S    | S    |
| Gravity Fresh Water Fill   | S    | S    | S    | S    |
| Enclosed Exterior Waste Station w/Discharge Valves                     | S    | S    | S    | S    |
| Trailer Hitch: 7-Way Round Tow Connection (8,000 lbs.)                 | S    | S    | S    | S    |
| Unidirectional KING® Controls Jack TV Antenna                          | S    | S    | S    | S    |
| LP Connection  | S    | S    | S    | S    |
| 4-Point Fully-Automatic Hydraulic Leveling Jacks                       | S    | S    | S    | S    |
| Rear Ladder  | S    | S    | S    | S    |
| Partial Paint w/Vinyl Graphics   | S    | S    | S    | S    |
| Full-Body Paint  | O    | O    | O    | O    |
| Roof Vent Rain Covers  | O    | O    | O    | O    |

|   |             |             |             |             |
|---|-------------|-------------|-------------|-------------|
| Roof-Mounted Satellite Dish Prep  | S           | S           | S           | S           |
| KING® Universal Satellite System  | O           | O           | O           | O           |
| <b>CAB EXTERIOR</b>   | <b>32RW</b> | <b>33HB</b> | <b>34MB</b> | <b>36DB</b> |
| Automotive-Style One-Piece Windshield   | S           | S           | S           | S           |
| Daytime Running Lights  | S           | S           | S           | S           |
| Driver and Passenger Slider Windows   | S           | S           | S           | S           |
| Fog Lamps   | S           | S           | S           | S           |
| Automotive-Style Windshield Wiper System  | S           | S           | S           | S           |
| Remote Power and Heated Mirrors w/Turn Signals and Side Cameras, Chrome/Black   | S           | S           | S           | S           |
| Sumo Springs  | O           | O           | O           | O           |
| Bilstein® Steering Stabilizer   | O           | O           | O           | O           |
| <b>CAB INTERIOR</b>   | <b>32RW</b> | <b>33HB</b> | <b>34MB</b> | <b>36DB</b> |
| Driver Chair w/Reclining Back, Swivel, and Manual Controls  | S           | S           | S           | S           |
| Driver Chair w/Reclining Back, Swivel, and 6-Way Power Controls   | O           | O           | O           | O           |
| Passenger Chair w/Reclining Back, Swivel, and Manual Controls   | S           | S           | S           | S           |
| Driver and Passenger ABS-Style Armrests   | S           | S           | S           | S           |
| Driver and Passenger Cupholders   | S           | S           | S           | S           |
| Power Windshield Roller Shade   | S           | S           | S           | S           |
| Driver and Passenger Manual Window Roller Shades  | S           | S           | S           | S           |
| Driver and Passenger Overhead Map Lighting  | S           | S           | S           | S           |
| Black Instrument Gauges w/Electronic Information Center   | S           | S           | S           | S           |
| High-Output Dash Air Conditioning and Heat  | S           | S           | S           | S           |
| Electronic Cruise Control   | S           | S           | S           | S           |
| Windshield Wipers w/Delay   | S           | S           | S           | S           |
| Remote Switch for Power and Heated Mirrors  | S           | S           | S           | S           |
| Steering Wheel w/Tilt Column  | S           | S           | S           | S           |
| 6" Color Monitor for Side/Rear Cameras  | S           | S           | S           | S           |
| Sony® 9" Stereo w/AM/FM/Bluetooth®/MP3/USB, Phone Control, Android® Auto and Apple® CarPlay® w/Navigation, Siri® Eyes Free, Built-In HD Radio, SiriusXM® Ready (Requires Subscription), and Backup Camera | S           | S           | S           | S           |

|   |             |             |             |             |
|---|-------------|-------------|-------------|-------------|
| Collision Mitigation  | O           | O           | O           | O           |
| USB and Auxiliary Inputs  | S           | S           | S           | S           |
| 3-Point Driver and Passenger Seatbelts w/Adjustable Straps              | S           | S           | S           | S           |
| 12V Accessory Ports   | S           | S           | S           | S           |
| 110V AC Outlets   | S           | S           | S           | S           |
| Automotive-Style Dash w/Dual Monitors and Work Station                  | S           | S           | S           | S           |
| Generator On/Off Switch   | S           | S           | S           | S           |
| Engine Cover w/Snack Tray   | S           | S           | S           | S           |
| Automatic Leveling Jack Controls  | S           | S           | S           | S           |
| Driver and Passenger Center Table                                       | S           | S           | S           | S           |
| Auxiliary Start Switch  | S           | S           | S           | S           |
| Hide-A-Loft™ Drop-Down Queen-Sized Bed                                  | S           | S           | S           | S           |
| <b>INTERIOR</b>   | <b>32RW</b> | <b>33HB</b> | <b>34MB</b> | <b>36DB</b> |
| Jackknife Sofa  | S           | S           | S           | S           |
| Theater Seating Sofa  | O           | O           | O           | O           |
| Facing Booth Dinette w/Dreameasy® Dinette Table and Single-Door Storage | S           | S           | S           | S           |
| Solid-Surface Galley Top w/Sink Covers                                  | S           | S           | S           | S           |
| Surf(x)® Tops Throughout (Excluding Galley)                             | S           | S           | S           | S           |
| Electric Fireplace  | —           | —           | S           | —           |
| Feature Wall w/Accent Wall Covering                                     | S           | S           | S           | S           |
| Feature Wall w/Surf(x)® Covering  | —           | —           | S           | —           |
| Flat Ceiling w/Soft-Touch Vinyl   | S           | S           | S           | S           |
| Vinyl Tile Flooring Throughout  | S           | S           | S           | S           |
| Non-Ozite Lined Cabinet Interiors w/Adjustable Shelving                 | S           | S           | S           | S           |
| Full-Extension Drawer Guides w/Latches                                  | S           | S           | S           | S           |
| Hidden Euro-Style Hinges and Struts                                     | S           | S           | S           | S           |
| Solid Wood Raised-Panel Cabinet Doors                                   | S           | S           | S           | S           |
| Galley Overhead Glass Inserts   | S           | S           | S           | S           |
| Hardwood Interior Wood Color Coordinating Slideout Fascia               | S           | S           | S           | S           |

Product information, photography and illustrations included in this publication were as accurate as possible at the time of printing

|   |             |             |             |             |
|---|-------------|-------------|-------------|-------------|
| Valances w/Lambrequins  | S           | S           | S           | S           |
| Manual Night Roller Shades  | S           | S           | S           | S           |
| Energy Efficient 3" LED Flush-Mounted Ceiling and Under Cabinet Reading Lights Throughout | S           | S           | S           | S           |
| Chrome Faucets, Fixtures, and Hardware  | S           | S           | S           | S           |
| <b>INTERIOR ENTRY</b>   | <b>32RW</b> | <b>33HB</b> | <b>34MB</b> | <b>36DB</b> |
| Battery Disconnect  | S           | S           | S           | S           |
| Metal Interior Grab Handle at Entry   | S           | S           | S           | S           |
| Entry Steps w/Pressed Tops  | S           | S           | S           | S           |
| <b>KITCHEN</b>  | <b>32RW</b> | <b>33HB</b> | <b>34MB</b> | <b>36DB</b> |
| Refrigerator: Insignia™ Residential, Stainless Steel                                      | S           | S           | S           | S           |
| Refrigerator: LP 8 cu.ft. Dometic®  | O           | O           | O           | O           |
| 3-Burner Cooktop  | S           | S           | S           | S           |
| Stainless Steel Over-the-Range Convection Microwave                                       | S           | S           | S           | S           |
| Tile Backsplash   | S           | S           | S           | S           |
| Sink: Stainless Steel Farmhouse-Style   | S           | S           | S           | S           |
| Residential Single-Handled Faucet w/ Pull-Out Sprayer                                     | S           | S           | S           | S           |
| Adjustable Shelves Throughout   | S           | S           | S           | S           |
| Power Ceiling Vent  | S           | S           | S           | S           |
| <b>BEDROOM OR BUNK AREA</b>   | <b>32RW</b> | <b>33HB</b> | <b>34MB</b> | <b>36DB</b> |
| King-Sized Bed  | S           | S           | S           | S           |
| Designer Bedspread, Headboard, Pillow Shams, and Pillows                                  | S           | S           | S           | S           |
| C-PAP Machine Prep in Bedroom Overhead Cabinetry  | S           | S           | S           | S           |
| 120V and USB Ports  | S           | S           | S           | S           |
| Reading Lights  | S           | S           | S           | S           |
| <b>BATHROOM</b>   | <b>32RW</b> | <b>33HB</b> | <b>34MB</b> | <b>36DB</b> |
| Sink: Top-Mounted, Stainless Steel  | S           | S           | S           | S           |
| Residential Faucet w/Single Handle  | S           | S           | S           | S           |
| Medicine Cabinet w/Mirror   | S           | S           | S           | S           |
| ABS Shower Surround   | S           | S           | S           | S           |
| Glass Shower Door   | S           | S           | S           | S           |
| Shower Skylight   | S           | S           | S           | S           |

|   |             |             |             |             |
|---|-------------|-------------|-------------|-------------|
| Metal Shower Head w/Sliding Adjustable Bar, Soap Dish, and Matching Single-Valve Faucet | S           | S           | S           | S           |
| Standard Toilet, Porcelain  | S           | S           | S           | S           |
| Macerator Toilet, Porcelain   | —           | S           | —           | S           |
| Power Ceiling Vent  | S           | S           | S           | S           |
| <b>ENTERTAINMENT</b>  | <b>32RW</b> | <b>33HB</b> | <b>34MB</b> | <b>36DB</b> |
| 32" Flat Screen LED TV (Bedroom)  | S           | S           | S           | S           |
| 39" Flat Screen Smart LED TV (Living Area)  | S           | S           | S           | S           |
| Ceiling Speakers in Living Area   | S           | S           | S           | S           |
| Bluetooth® Coach System in Bedroom w/Exterior Speakers                                  | S           | S           | S           | S           |
| Exterior Entertainment Center: 50" LED TV   | S           | S           | S           | S           |
| <b>ELECTRIC AND UTILITIES</b>   | <b>32RW</b> | <b>33HB</b> | <b>34MB</b> | <b>36DB</b> |
| A/C: Dual 13,500 BTU  | S           | S           | S           | S           |
| Furnace: 20,000 BTU *36DB in Front  | —           | —           | —           | S*          |
| Furnace: 30,000 BTU *36DB in Rear   | S           | S           | —           | S*          |
| Furnace: 34,000 BTU   | —           | —           | S           | —           |
| 50 Amp Service  | S           | S           | S           | S           |
| 55 Amp Power Converter  | S           | S           | S           | S           |
| Inverter: Single 2000w  | S           | S           | S           | S           |
| WiFiRanger™ Sky4  | S           | S           | S           | S           |
| 100W Solar Panel  | S           | S           | S           | S           |
| Multiplex Wiring Control System w/4.3" Touch Screen Panel                               | S           | S           | S           | S           |
| 6V Auxiliary Batteries (4)  | S           | S           | S           | S           |
| Generator: 5.5kW Onan Quiet   | S           | S           | S           | S           |
| Automatic Generator Start   | S           | S           | S           | S           |
| Master Battery Disconnect Switch  | S           | S           | S           | S           |
| Water Pump: 12V 3GPM High-Capacity SHURflo® Water Pump                                  | S           | S           | S           | —           |
| Water Pump: 12V 5.3GPM High-Capacity AquaJet Water Pump                                 | —           | —           | —           | S           |
| Water Purification System   | S           | S           | S           | S           |
| Water Heater Bypass System  | S           | S           | S           | S           |
| City Water Hook-Up  | S           | S           | S           | S           |
| Exterior Shower   | S           | S           | S           | S           |

|  |   |   |   |   |
|--|---|---|---|---|
| Cable TV and Satellite Hookup  | S | S | S | S |
| San-T-Flush™ Black Holding Tank Flush System   | S | S | S | S |
| Single-Location Monitor Panel w/LPG, Touch Sensor Tank Monitoring and Battery Readouts | S | S | S | S |
| LP, Carbon Monoxide, and Smoke Detectors, Fire Extinguisher                            | S | S | S | S |
| GFCI Receptacle in Exterior Storage  | S | S | S | S |
| Combination Washer and Dryer Prep  | S | S | S | S |
| Combination Washer and Dryer   | O | O | O | O |
| Stackable Washer and Dryer   | O | O | O | O |

#### DEEP ADDITIONAL STORAGE AND CLOSET SPACE

This innovative feature functions like a lazy susan with the additional pantry item shelf storage and with a simple turn of the door to reveal behind a large shelving stow area. Available on the 34MB floorplan.



Pantry shelves

Deep storage shelves behind the pantry shelves

\*Fortis 36DB, 20,000 BTU Furnace in Front, 30,000 BTU Furnace in Rear





FORTIS — OUTSTANDING STANDARDS AND OPTIONS

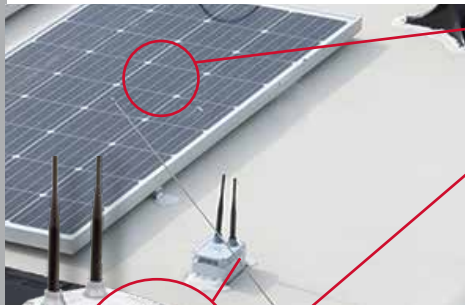

**RENEWABLE SAFE POWER**  
Each Fortis comes standard with a 100 watt solar panel.



**WiFi RANGER™ SKY4 DC**  
Boost a weak signal to get online in no time with this private secure WiFi booster.



**BONDED WINDSHIELD**  
Feel safer with this automotive style curved bonded windshield. This automotive inspired design bonds the windshield along the entire perimeter of the glass. This increases the structural strength and also reduces the risk of stress cracks.



**CREATIVE SPACE CONFIGURATION**  
Facing booth dinette with Dreameasy® dinette table and storage on all floorplans.



**KING EURO TOP MATTRESS**  
Sleep like royalty in this spacious 76" x 72" luxurious residential style bed with a euro top mattress. Shown 32RW Midtown decor with Heritage cabinetry. Includes 120V and USB ports by bed and reading lights overhead.

**AUTO GENERATOR START**  
Batteries need charging? A/C needs to kick on? This feature will automatically turn on your generator to give them some juice and then turn off when they have enough charge. This feature is conveniently found in the Precision Circuits touch panel.



**HIDE-A-LOFT™ DROP DOWN BED**  
Invite more guests on your road trip without compromising space with this queen bed, featuring industry-leading headroom and up to 600 lb capacity.



**EXTERIOR STORAGE (32RW, 33HB ONLY)**  
Additional above the belt line storage is standard on the 32RW, 33HB floorplans.



**EXTERIOR ENTERTAINMENT CENTER**  
Every Fortis is standard equipped with an exterior entertainment center with 50" LED TV for additional entertaining space.



**AUTO HYDRAULIC LEVELING SYSTEM (STANDARD)**  
Save time and avoid hassle by leveling and stabilizing your RV with the push of a button.

**CONFIDENCE BEHIND THE WHEEL**  
From behind the wheel you will feel the power and feel in total control with digital information gauges, cruise control, 6" color monitor for side and rear cameras, Sony® 9" stereo system with Bluetooth® connectivity, CarPlay®, and SiriusXM® ready along with a backup camera.



**BILSTEIN® STEERING STABILIZER SYSTEM (OPTIONAL)**  
A shock absorber system that dampens the bumps and vibrations of the road in the steering system. Allows for easier control to the front-end steering.

**WASHER/DRYER OPTIONS (UPGRADE)**  
All the amenities of home-sweet-home with washer and dryer options available. Choose from an all-in one combo unit or a stackable unit conveniently tucked away in the master bedroom.



**ALCOA® WHEELS (STANDARD)**  
Every Fortis is equipped with Alcoa wheels. Alcoa wheels are designed for increased load requirements. Not only do these wheels look good but they are made to last for the long haul with less maintenance.



## FORTIS SPECIFICATIONS

| CHASSIS                   | 32RW   | 33HB   | 34MB   | 36DB   |
|---------------------------|--------|--------|--------|--------|
| Wheelbase (inches)        | 228"   | 228"   | 242"   | 252"   |
| Front GAWR (lbs)          | 8,000  | 8,000  | 9,000  | 9,000  |
| Rear GAWR (lbs)           | 15,000 | 15,000 | 15,000 | 17,500 |
| GCWR (lbs)                | 26,000 | 26,000 | 26,000 | 30,000 |
| GVWR (lbs)                | 22,000 | 22,000 | 22,000 | 26,000 |
| Hitch Rating Weight (lbs) | 8,000  | 8,000  | 8,000  | 8,000  |
| Tongue Weight (lbs)       | 800    | 800    | 800    | 800    |
| Fuel Capacity (gal)       | 80     | 80     | 80     | 80     |

| DIMENSIONS AND CAPACITIES         | 32RW    | 33HB    | 34MB    | 36DB     |
|-----------------------------------|---------|---------|---------|----------|
| Overall Length (inches)           | 34' 6"  | 35' 0"  | 35' 6"  | 38' 11"  |
| Overall Height (with A/C)         | 12' 10" | 12' 10" | 12' 10" | 12' 10"  |
| Overall Width (maximum)           | 100"    | 100"    | 100"    | 100"     |
| Interior Height (maximum)         | 82"     | 82"     | 82"     | 82"      |
| Interior Width (maximum)          | 96"     | 96"     | 96"     | 96"      |
| Patio Awning Width (ft./in.)      | 14' 0"  | 14' 0"  | 20' 0"  | 12' 0"   |
| Interior Storage (cu. ft.)        | 153     | 152     | 128     | 148      |
| Exterior Storage (cu. ft.)        | 138     | 145     | 134     | 120      |
| Fresh Water Holding Tank (gal)    | 100     | 100     | 100     | 100      |
| Grey Water Holding Tank (gal)     | 50      | 50      | 50      | 80       |
| Black Water Holding Tank (gal)    | 50      | 50      | 50      | 50       |
| Appliance Propane Tank (gal) (WC) | 25      | 25      | 25      | 25       |
| Water Heater Tank (gal)           | 10      | 10      | 10      | TANKLESS |

### FORD® CHASSIS

Model: Ford®

Engine: 7.3L Triton V8

Transmission: Ford® 6-Speed, Automatic w/Overdrive

Alternator: 175 Amp

Torque: 468 lb.-ft. @ 3,000 RPM

Horsepower: 350HP @ 3,900 RPM



### DISCLAIMERS

1. GVWR (Gross Vehicle Weight Rating) is the maximum permissible weight of this fully loaded motorhome. The GVWR is equal to or greater than the sum of the (UVW) unloaded vehicle weight plus the (OCCC) occupant cargo-carrying capacity.
  2. GAWR (Gross Axle Weight Rating) is the maximum permissible loaded weight a specific axle is designed to carry.
  3. GCWR (Gross Combined Weight Rating) is the value specified by the motor home manufacturer as the maximum allowable loaded weight of this motorhome with its towed vehicle. Towing and braking capacities may be different. Refer to Fleetwood and chassis manufacturer's manuals for complete information.
  4. Length measured from front bumper to rear bumper (excludes accessories).
  5. Excludes safety equipment and awnings.
  6. Motorhomes feature a body width over 96" which will restrict your access to certain roads. Before purchasing, you should research any state and/or province road laws which may affect your usage.
  7. Tank manufacturer's listed water capacity (WC). Actual propane capacity is 80% of water listing as required by the safety code.
- † The chassis manufacturer recommends the installation of a supplemental brake control system to activate the brakes on the vehicle or trailer you are towing. Hitch receiver ratings expressed are maximum for the hitch receiver installed and may require the purchase of additional equipment that is dependent on the weight of the towed load. Consult with hitch receiver manufacturer for further information.

\* UVW and OCCC are found on the label containing the federal certification tag in each RV.

\*\*\* All 2021 REV Recreation Group motorhomes include a limited one year/15,000-mile coach warranty and three-year/45,000-mile structural warranty, whichever occurs first, and is fully transferable for the first 12 months.

### FLEETWOOD MOTORHOME ASSOCIATION

As a Fleetwood RV owner, you're invited to become a member of the Fleetwood Motorhome Association (FMA). Becoming a member is the perfect way to meet other Fleetwood owners who love to travel across America and share in the RV lifestyle. Visit the FMA website at [www.fma4fun.org](http://www.fma4fun.org) to learn more and join the fun.

### CONTACT US

To locate a dealer near you, visit our website at [www.fleetwoodrv.com](http://www.fleetwoodrv.com) or call 1-800-322-8216. We can also be contacted at Fleetwood RV Customer Relations, P.O. Box 1007, Decatur, IN 46733.

**IMPORTANT—PLEASE READ:** Product information, photography and illustrations included in this publication were as accurate as possible at the time of printing. For further product information and changes, please visit our website at [www.fleetwoodrv.com](http://www.fleetwoodrv.com) or contact your local Fleetwood RV dealer. Prices, materials, design and specifications are subject to change without notice. All weights, fuel, liquid capacities and dimensions are approximate. Fleetwood RV has designed its recreational vehicles to provide a variety of uses for its customers. Each vehicle features optimal seating, sleeping, storage and fluid capacities. The user is responsible for selecting the proper combination of loads (i.e., occupants, equipment, fluids, cargo, etc.) to ensure that the vehicle's capacities are not exceeded.

YOUR LOCAL DEALER

# Explore Your World Like Never Before



About REV Group, Inc.



REV Group® (REVG) is a leading designer, manufacturer, and distributor of specialty vehicles and related aftermarket parts and services. We serve a diversified customer base, primarily in the United States, through three segments: Fire & Emergency, Commercial, and Recreation. We provide customized vehicle solutions for applications, including essential needs for public services (ambulances, fire apparatus, school buses, and transit buses), commercial infrastructure (terminal trucks and industrial sweepers) and consumer leisure (recreational vehicles). Our diverse portfolio is made up of well-established principal vehicle brands, including many of the most recognizable names within their industry. Several of our brands pioneered their specialty vehicle product categories and date back more than 50 years. REV Group trades on the NYSE under the symbol REVG. Investors-REVG



IMPORTANT—PLEASE READ: Product information, photography and illustrations included in this publication were as accurate as possible at the time of printing. For further product information and changes, please visit our website at [www.fleetwoodrv.com](http://www.fleetwoodrv.com) or contact your local Fleetwood RV dealer. Prices, materials, design and specifications are subject to change without notice. All weights, fuel, liquid capacities and dimensions are approximate. Fleetwood RV has designed its recreational vehicles to provide a variety of uses for its customers. Each vehicle features optimal seating, sleeping, storage and fluid capacities. The user is responsible for selecting the proper combination of loads (i.e., occupants, equipment, fluids, cargo, etc.) to ensure that the vehicle's capacities are not exceeded.

**FleetwoodRV.com**

©2020 REV Group, Inc. Printed in the USA. 11/20. Model Year 2021, First Edition.

Part #: L93-0030-21



## OUR VERY OWN FLEETWOOD RV MOTORHOME SERVICE CENTERS

At Fleetwood RV, we strive to deliver peace-of-mind at every turn. Our devotion to customer service starts with our trusted dealer network and spans to our own staff of motorhome service professionals at REV Recreation Group's regional technical centers. The motorhome service centers are strategically located throughout the United States to provide you convenient service wherever the road takes you.

Below, you'll find the closest motorhome service center, as well as a list of the other centers. Please visit [www.fleetwoodrv.com/motorhome-service-centers](http://www.fleetwoodrv.com/motorhome-service-centers) to schedule a Service Appointment.

### East Coast

REV RV SERVICE & REPAIR  
800-509-3417

### West Coast

REV RV SERVICE & REPAIR  
877-466-6226

## ROADSIDE ASSISTANCE. ANYWHERE. ANYTIME.

24/7 CUSTOMER SUPPORT FOR:

- FUEL
- BATTERY
- LOCKSMITH
- TOWING
- SLIDE-OUT ISSUES
- AND MUCH MORE!

**1-855-268-0414**



One-year of REV Assist is free with the purchase of any new 2021 Fleetwood. You may extend your coverage after the first year at [www.revgroup.com/rev-assist](http://www.revgroup.com/rev-assist).